

THIS DRAWING IS UNPUBLISHED. RELEASED FOR PUBLICATION
 © COPYRIGHT BY TYCO ELECTRONICS CORPORATION. ALL INTERNATIONAL RIGHTS RESERVED.

LOC		DIST		REVISIONS			
AD	00	P	LTR	DESCRIPTION	DATE	DWN	APVD
		H1		REVISED PER ECO-08-019092	05AUG08	HMR	JO

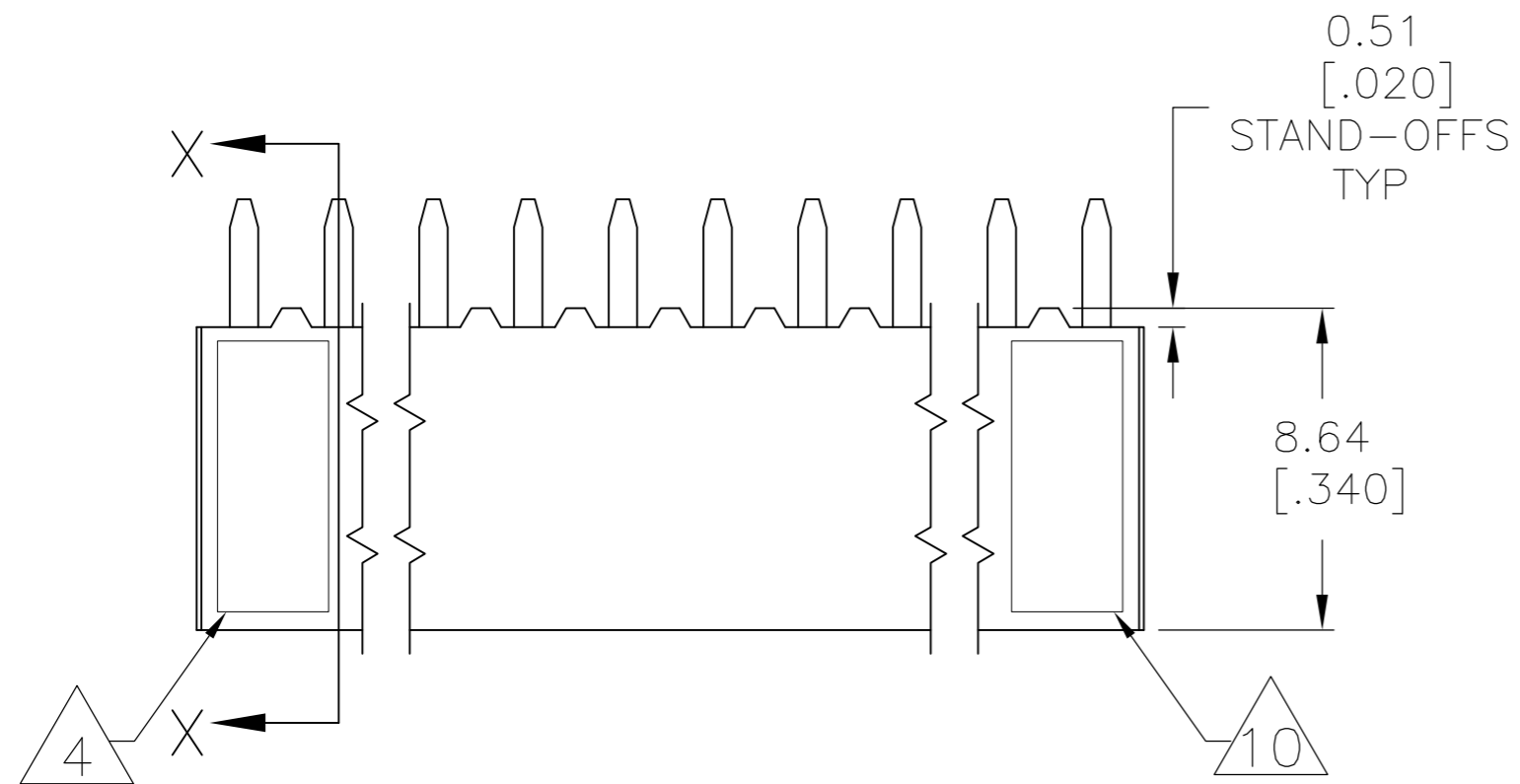

- 1 HOUSING: FLAME RETARDANT, GLASS FILLED, POLYESTER, COLOR: BLACK. CONTACT: PHOSPHOR BRONZE
- 2 CONTACT: 3.81-7.62 MICROMETERS (.000150-.000300) BRIGHT TIN-LEAD OVER 1.27 MICROMETERS (.000050) MINIMUM NICKEL.
- 3 THESE DIMENSIONS PERTAIN TO CAVITY CENTERLINES ONLY - NOT TO CONTACT LOCATIONS
- 4 PART NUMBER AND DATE CODE ARE MARKED IN APPROXIMATE LOCATION SHOWN.
- 5 TOLERANCE IS NON-CUMULATIVE.
- 6 2 POSITION DATE CODE IS MARKED OPPOSITE SIDE OF TE LOGO.
- 7 POINT-OF-MEASUREMENT DIMENSION FOR PLATING THICKNESS (INSIDE CONTACT BEAM).
- 8 POINT-OF-CONTACT DIMENSION.
- 9 NO PART NUMBER MARKING REQUIRED FOR THIS PART.
- 10 TE LOGO AND CSA LOGO ARE MOLDED INTO HOUSING.
- 11 CONTACT: 3.81-7.62 MICROMETERS (.000150-.000300) MATTE TIN OVER 1.27 MICROMETERS (.000050) MINIMUM NICKEL."
- 12 ROHS 2002/95/EC COMPLIANT

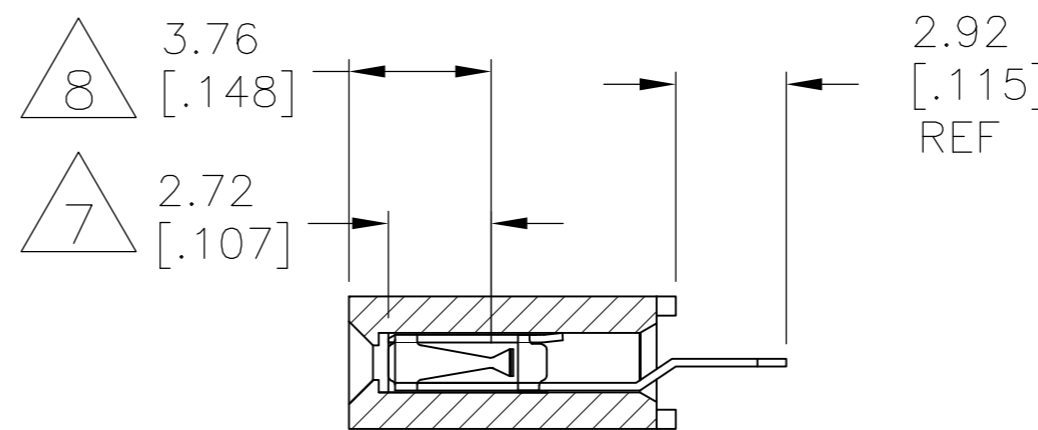
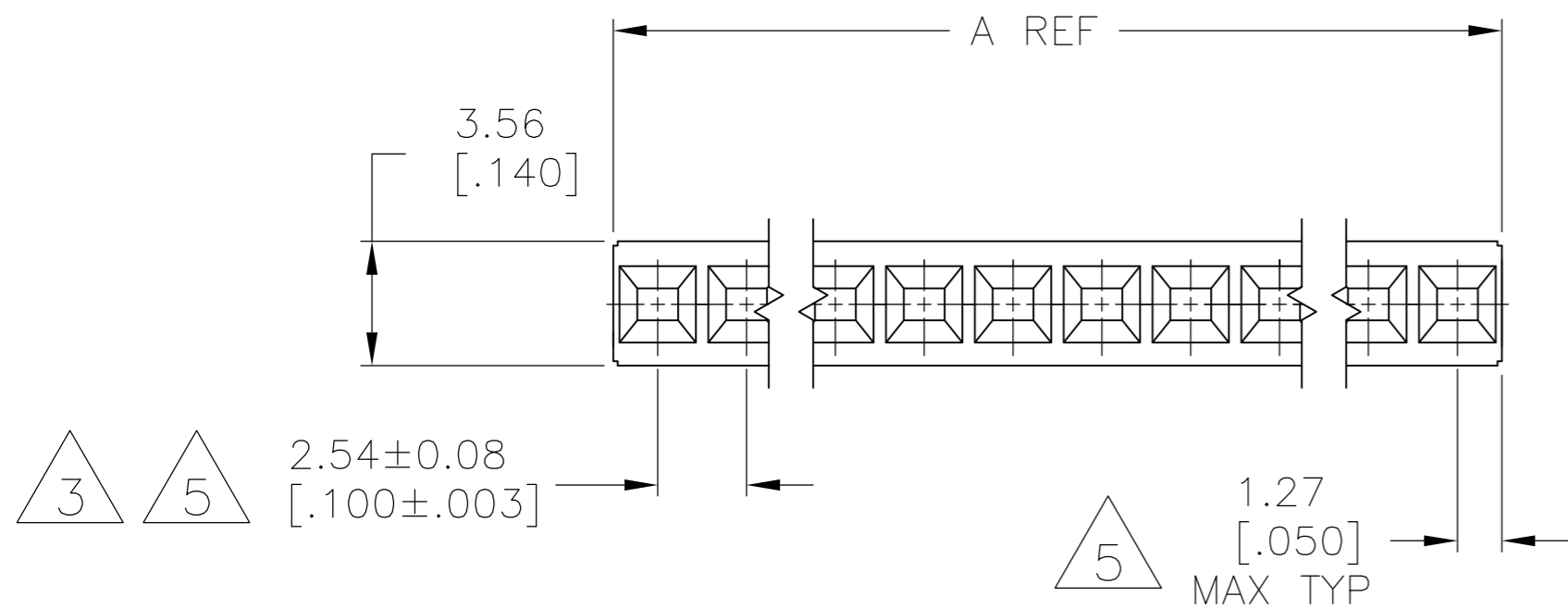

SECTION X-X

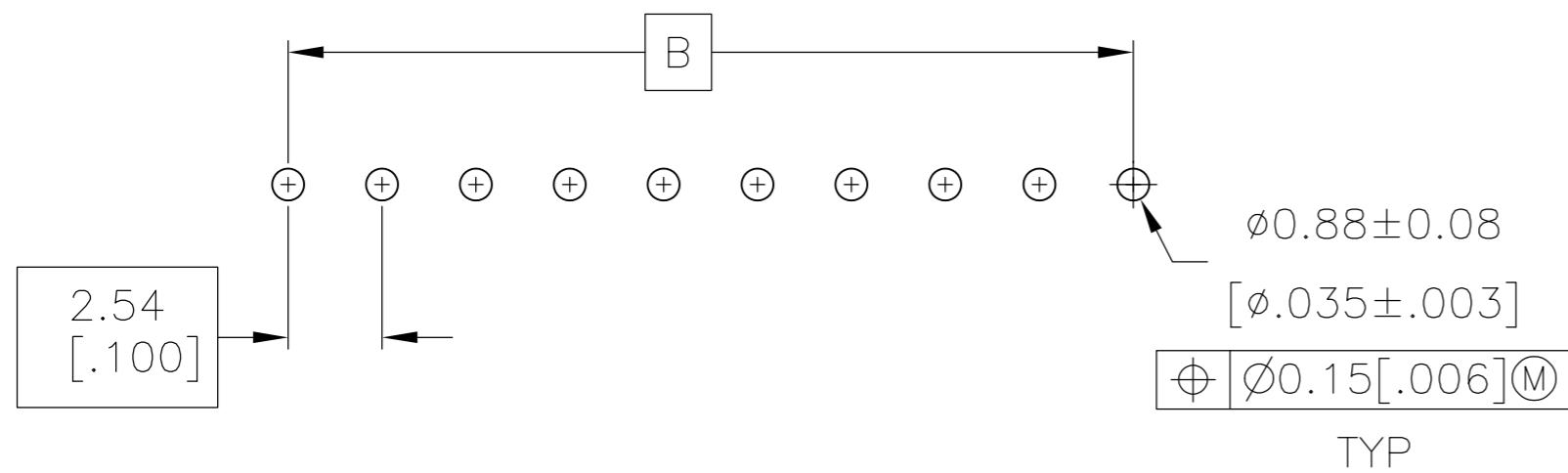

RECOMENDED PC BD LAYOUT

THIS DRAWING IS A CONTROLLED DOCUMENT.		DWN M.BINNER 05NOV02	Tyco Electronics Corporation Harrisburg, Pa 17105-3608
DIMENSIONS: mm [INCHES]		CHK J.OLSON 05NOV02	
TOLERANCES UNLESS OTHERWISE SPECIFIED:		APVD J.OLSON 05NOV02	NAME RECPT.ASSY, MOD IV, SINGLE ROW, .100CL, VERTICAL BOARD MOUNT, CLOSED, TOP ENTRY, SHORT PNT. OF CONTACT
0 PLC ± -	1 PLC ± -	PRODUCT SPEC 108-25022	SIZE A2
2 PLC ± 0.25[.010]	3 PLC ± 0.13[.005]	APPLICATION SPEC 114-25018	CAGE CODE 00779
4 PLC ± -	ANGLES ± -	WEIGHT -	DRAWING NO C=146763
MATERIAL 1	FINISH 2 11	CUSTOMER DRAWING	RESTRICTED TO -
		SCALE 5:1	SHEET 1 of 2
		REV H1	

THIS DRAWING IS UNPUBLISHED. RELEASED FOR PUBLICATION
 © COPYRIGHT BY TYCO ELECTRONICS CORPORATION. ALL INTERNATIONAL RIGHTS RESERVED.

LOC	DIST	REVISIONS					
AD	00	P	LTR	DESCRIPTION	DATE	DWN	APVD
		-	-	SEE SHEET 1	-	-	-

9	11	2.54 [.100]	5.08 [.200]	2	12	8-146763-9
11	11	99.06 [3.900]	101.60 [4.000]	40	12	8-146763-8
11	11	96.52 [3.800]	99.06 [3.900]	39	12	8-146763-7
11	11	93.98 [3.700]	96.52 [3.800]	38	12	8-146763-6
11	11	91.44 [3.600]	93.98 [3.700]	37	12	8-146763-5
11	11	88.90 [3.500]	91.44 [3.600]	36	12	8-146763-4
11	11	86.36 [3.400]	88.90 [3.500]	35	12	8-146763-3
11	11	83.82 [3.300]	86.36 [3.400]	34	12	8-146763-2
11	11	81.28 [3.200]	83.82 [3.300]	33	12	8-146763-1
11	11	78.74 [3.100]	81.28 [3.200]	32	12	8-146763-0
11	11	76.20 [3.000]	78.74 [3.100]	31	12	7-146763-9
11	11	73.66 [2.900]	76.20 [3.000]	30	12	7-146763-8
11	11	71.12 [2.800]	73.66 [2.900]	29	12	7-146763-7
11	11	68.58 [2.700]	71.12 [2.800]	28	12	7-146763-6
11	11	66.04 [2.600]	68.58 [2.700]	27	12	7-146763-5
11	11	63.50 [2.500]	66.04 [2.600]	26	12	7-146763-4
11	11	60.96 [2.400]	63.50 [2.500]	25	12	7-146763-3
11	11	58.42 [2.300]	60.96 [2.400]	24	12	7-146763-2
11	11	55.88 [2.200]	58.42 [2.300]	23	12	7-146763-1
11	11	53.34 [2.100]	55.88 [2.200]	22	12	7-146763-0
11	11	50.80 [2.000]	53.34 [2.100]	21	12	7-146763-0
11	11	48.26 [1.900]	50.80 [2.000]	20	12	6-146763-9
11	11	45.72 [1.800]	48.26 [1.900]	19	12	6-146763-8
11	11	43.18 [1.700]	45.72 [1.800]	18	12	6-146763-7
11	11	40.64 [1.600]	43.18 [1.700]	17	12	6-146763-6
11	11	38.10 [1.500]	40.64 [1.600]	16	12	6-146763-5
11	11	35.56 [1.400]	38.10 [1.500]	15	12	6-146763-4
11	11	33.02 [1.300]	35.56 [1.400]	14	12	6-146763-3
11	11	30.48 [1.200]	33.02 [1.300]	13	12	6-146763-2
11	11	27.94 [1.100]	30.48 [1.200]	12	12	6-146763-1
11	11	25.40 [1.000]	27.94 [1.100]	11	12	6-146763-0
11	11	20.32 [.800]	22.86 [.900]	9	12	5-146763-9
11	11	12.70 [.500]	15.24 [.600]	6	12	5-146763-8
9	11	10.16 [.400]	12.70 [.500]	5	12	5-146763-7
9	11	7.62 [.300]	10.16 [.400]	4	12	5-146763-6
9	11	5.08 [.200]	7.62 [.300]	3	12	5-146763-5
11	11	58.42 [2.300]	60.96 [2.400]	24	12	5-146763-4
11	11	22.86 [.900]	25.40 [1.000]	10	12	5-146763-3
11	11	17.78 [.700]	20.32 [.800]	8	12	5-146763-2
11	11	15.24 [.600]	17.78 [.700]	7	12	5-146763-1
	FINISH 11	B	A	NO OF POSN		PART NUMBER

9	2	2.54 [.100]	5.08 [.200]	2	6	3-146763-9
2	2	99.06 [3.900]	101.60 [4.000]	40	6	3-146763-8
2	2	96.52 [3.800]	99.06 [3.900]	39	6	3-146763-7
2	2	93.98 [3.700]	96.52 [3.800]	38	6	3-146763-6
2	2	91.44 [3.600]	93.98 [3.700]	37	6	3-146763-5
2	2	88.90 [3.500]	91.44 [3.600]	36	6	3-146763-4
2	2	86.36 [3.400]	88.90 [3.500]	35	6	3-146763-3
2	2	83.82 [3.300]	86.36 [3.400]	34	6	3-146763-2
2	2	81.28 [3.200]	83.82 [3.300]	33	6	3-146763-1
2	2	78.74 [3.100]	81.28 [3.200]	32	6	3-146763-0
2	2	76.20 [3.000]	78.74 [3.100]	31	6	2-146763-9
2	2	73.66 [2.900]	76.20 [3.000]	30	6	2-146763-8
2	2	71.12 [2.800]	73.66 [2.900]	29	6	2-146763-7
2	2	68.58 [2.700]	71.12 [2.800]	28	6	2-146763-6
2	2	66.04 [2.600]	68.58 [2.700]	27	6	2-146763-5
2	2	63.50 [2.500]	66.04 [2.600]	26	6	2-146763-4
2	2	60.96 [2.400]	63.50 [2.500]	25	6	2-146763-3
2	2	58.42 [2.300]	60.96 [2.400]	24	6	2-146763-2
2	2	55.88 [2.200]	58.42 [2.300]	23	6	2-146763-1
2	2	53.34 [2.100]	55.88 [2.200]	22	6	2-146763-0
2	2	50.80 [2.000]	53.34 [2.100]	21	6	2-146763-0
2	2	48.26 [1.900]	50.80 [2.000]	20	6	1-146763-9
2	2	45.72 [1.800]	48.26 [1.900]	19	6	1-146763-8
2	2	43.18 [1.700]	45.72 [1.800]	18	6	1-146763-7
2	2	40.64 [1.600]	43.18 [1.700]	17	6	1-146763-6
2	2	38.10 [1.500]	40.64 [1.600]	16	6	1-146763-5
2	2	35.56 [1.400]	38.10 [1.500]	15	6	1-146763-4
2	2	33.02 [1.300]	35.56 [1.400]	14	6	1-146763-3
2	2	30.48 [1.200]	33.02 [1.300]	13	6	1-146763-2
2	2	27.94 [1.100]	30.48 [1.200]	12	6	1-146763-1
2	2	25.40 [1.000]	27.94 [1.100]	11	6	1-146763-0
2	2	20.32 [.800]	22.86 [.900]	9	6	146763-9
2	2	12.70 [.500]	15.24 [.600]	6	6	146763-8
9	2	10.16 [.400]	12.70 [.500]	5	6	146763-7
9	2	7.62 [.300]	10.16 [.400]	4	6	146763-6
9	2	5.08 [.200]	7.62 [.300]	3	6	146763-5
2	2	58.42 [2.300]	60.96 [2.400]	24	6	146763-4
2	2	22.86 [.900]	25.40 [1.000]	10	6	146763-3
2	2	17.78 [.700]	20.32 [.800]	8	6	146763-2
2	2	15.24 [.600]	17.78 [.700]	7	6	146763-1
	FINISH 11	B	A	NO OF POSN		PART NUMBER

THIS DRAWING IS A CONTROLLED DOCUMENT.		DWN M.BINNER 05NOV02	Tyco Electronics Corporation Harrisburg, Pa 17105-3608	
DIMENSIONS: mm [INCHES]		CHK J.OLSON 05NOV02	NAME RECPT.ASSY, MOD IV, SINGLE ROW, .100CL, VERTICAL BOARD MOUNT, CLOSED, TOP ENTRY, SHORT PNT. OF CONTACT	
TOLERANCES UNLESS OTHERWISE SPECIFIED: 0 PLC ± - 1 PLC ± - 2 PLC ± 0.25[.010] 3 PLC ± 0.13[.005] 4 PLC ± - ANGLES ± -		APVD J.OLSON 05NOV02	PRODUCT SPEC 108-25022	
MATERIAL 1		APPLICATION SPEC 114-25018	SIZE A2	CAGE CODE 00779
FINISH 2 11		WEIGHT -	DRAWING NO C=146763	RESTRICTED TO -
CUSTOMER DRAWING			SCALE 1:1	SHEET 2 OF 2 REV H1